

Technical Specifications

STARVIS 4K 180° IR Bullet AI IP Camera

FOR EXTERNAL APPLICATION

- 30fps at 8MP
- H.265, H.264 and MJPEG compression
- Horizontal FOV 180° & Vertical FOV 80°
- Deep Learning - Object Tracker/People Tracker
- SMART Bitrate Control and Region of Interest
- Power over Ethernet (IEEE 802.3af)



CAMERA	
Model	IPAi66A08-FR
Image Sensor	SONY STARVIS2 1/1.8" 8.48M CMOS
Effective Pixels	3840(H) x 2160(V)
Scanning System	Progressive scanning
AGC Control	Auto
IRIS Type	Auto Exposure
Minimum Illumination	Color: 0.15 Lux / B/W : 0 Lux (IR LED On)
Lens	2.3mm, F2.8
Angle of View	Horizontal: Approx. 180°, Vertical: Approx. 80°
Shutter Time	Auto / Manual: 1/30 ~ 1/32,000, Anti-Flicker, Slow Shutter (1/2, 1/3, 1/5, 1/6, 1/7.5, 1/10)
Day & Night	True Day & Night (Removable IR-cut filter)
Wide Dynamic Range	True WDR (Max. 15fps when WDR is on)
S/N Ratio	50 dB

IR ILLUMINATOR	
IR LED	4 x High Power LED
IR Working Distance	25m

VIDEO	
Video Compression	H.265, H.264, MJPEG
Profile	H.264 : MP / HP H.265 : MP
Multiple Profile Streaming Performance	3840x2160/30 + 800x600/30 with H.264, H.265 + MJPEG
Max Resolution	3840 x 2160
Video Bit Rate	100Kbps ~ 25Mbps Multi-rate for Preview and Recording
Bitrate Control	Multi Streaming CBR/VBR (Controllable frame rate and Bandwidth)
Digital Noise Reduction	3D-DNR
Privacy Mask	-
Special Features	SMART Bitrate Control, Region of Interest
Other Image Processing	Configurable Exposure, White Balance, Sharpness
Image Orientation	Flip / Mirror
Analogue Output	1 (Installation only) CVBS 1.0V p-p (75Ω), 4:3 aspect ratio

AUDIO	
Audio Streaming	Two way
Audio Compression	G.711 u-law 8KHz, AAC-LC 48Kbps at 8KHz
Audio input	Supply voltage : 3VDC(3mA), Input impedance : 3K Ohm
Audio output	Line Out, MAX. Output Level : 1Vrms

EVENT	
Event Trigger	Motion Alarm, Temperature critical, DI, VCA(AI)
Pre-Post Recording	Pre: 1~5 sec Post: 1~240 sec
Event Notification	FTP, E-mail, Alarm-out, SD card

NETWORK	
Ethernet Standard	10 / 100 / 1000Base-T
IP	IPv4
Protocol	TCP/IP, UDP, AutoIP, RTP(UDP/TCP), RTSP, NTP, HTTP, HTTPS, SSL, DNS, DDNS, DHCP, FTP, SMTP, ICMP, SNMPv1/v2/v3(MIB-2), ONVIF
Security	HTTPS(SSL), IP filtering, 802.1x, Digest Authentication
Plug In	ONVIF Profile S, CGI API

GENERAL	
Material	Aluminum Die-casting, White
External I/O Terminals	1 x Alarm In / 1 x Alarm Out
Language on webpage	English
Power Source	DC12V, PoE(IEEE 802.3af)
Power Consumption	DC12V Max 22W, PoE Max 9.2W
Operating Conditions	Humidity 10 ~ 90% RH (non-condensing) [DC12V] -40°C ~ 50°C (-40°F ~ 122°F) [PoE] -30°C ~ 50°C (-22°F ~ 122°F)
Approvals	FCC, CE, IP67, IK09
NDAA	Compliant
Weight	0.97 kg
Dimensions (D x H)	228mm x 96.7mm

EDGE STORAGE	
Storage	1x microSD / microSDHC / microSDXC (card not included)

Technical Specifications

VIDEO ANALYTICS

Features

Analytics Engine VCA Technology's advanced tracking algorithm with rich library of detection behaviors

Detection Zones and Rules 40 rules & zones (Multi-segment Polygons and Lines) as standard

Intrusion Detection Detection of the presence of an object

Tamper Detection Supported as standard

Detection Behavior Enter, Exit, Appear, Disappear, Stop, Direction, Dwell filter, Tailgating

Logical Rules Extends standard rules to allow various combinations of the inputs

Deep Learning Object Tracking Deep learning based object identification (as Person, Cyclist, Car, Van, Truck, Motorcycle, Bicycle, Bag) removes false object detection

Deep Learning People Tracking Deep learning based people identification and tracking

Counting & Line High accuracy people and vehicle counting, 20 counters in total

Meta Data JSON format, Plain XML format that contains the event information and the tracked object information with the bounding box, tail history, object attributions (object type and color)

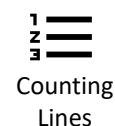

Technical Specifications

Dimensions

(Unit: mm)

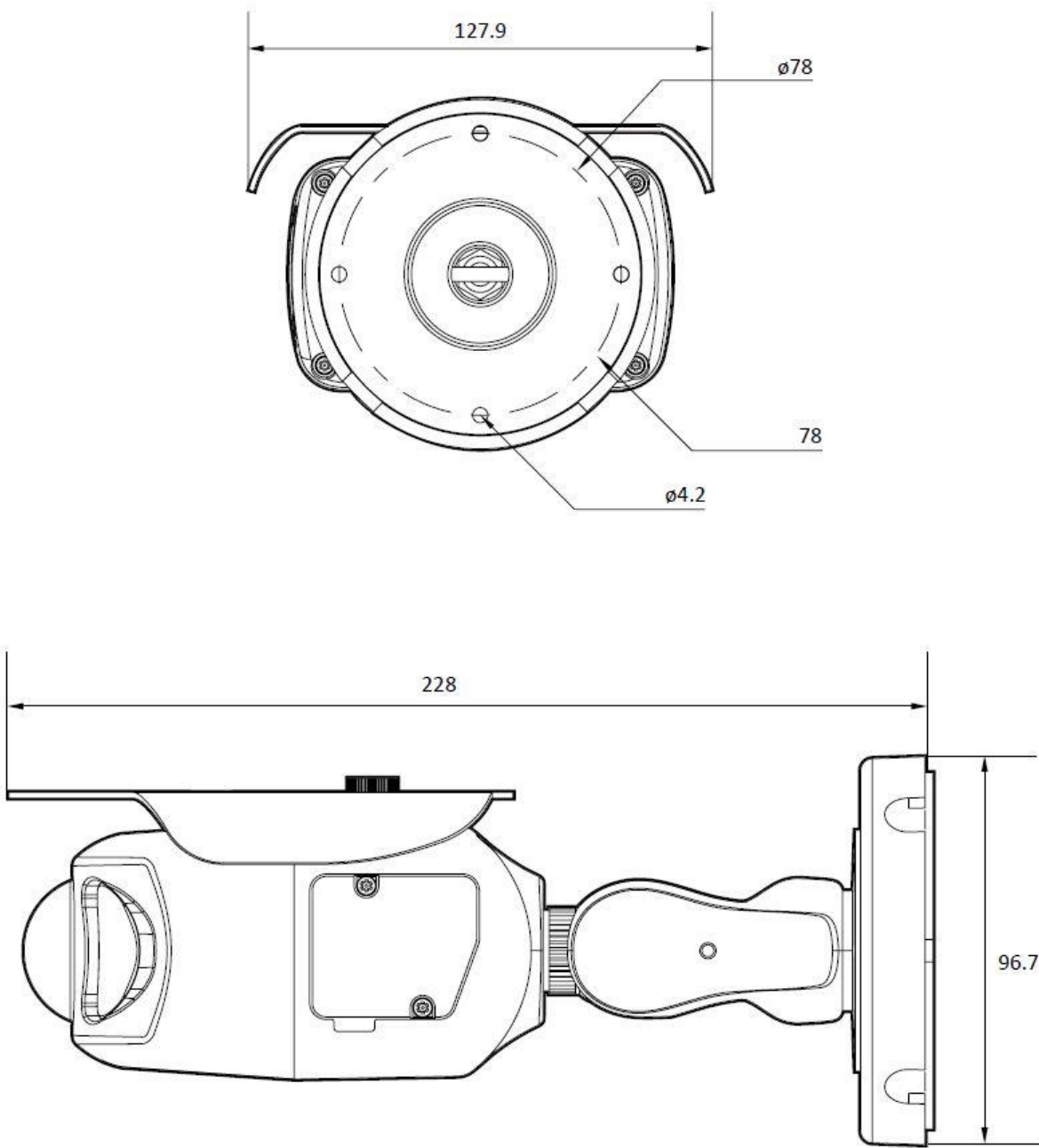

Accessories



BP01

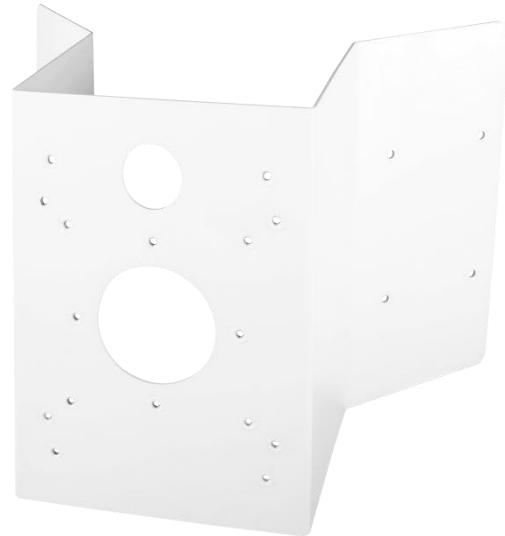

BCO01



BJC07